



**STRONG PARTNERS.
TOUGH TRUCKS.™**



HYSTER UT SERIES

ELECTRIC RIDER STACKER

SL1.5UTS / 1500KG

HYSTER.COM.AU

ADVANTAGES

SL1.5UTS

THE HYSTER® ELECTRIC WALKIE STACKER SL1.5UTS IS DESIGNED FOR PRODUCTIVITY AND FLEXIBILITY. COMBINING SIMPLE TO USE CONTROLS FOR EASY MANOEUVRABILITY, AND TECHNOLOGY FEATURES TO MAXIMISE OPERATOR PERFORMANCE.

Productivity

- Maintenance free AC motors
- Multi-function display with BDI and hour meter
- Handle equipped with emergency reversing device
- Auto deceleration function makes operation more productive
- Low speed switch
- Variable speed control
- Sideways battery removal is easy to maintain
- Cushioning for low-noise operation
- Built-in pressure relief valve protects from overloads and increases reliability
- Emergency power disconnect switch
- 240Ah traction battery
- Cold storage configuration (option)
- Narrow leg option for Australian market

Optimum Structural Design

- Low centre of gravity enhances stability
- Full free lift mast options for low overhead clearance
- Durable plastic covers
- Adjustable balance caster wheel improves stability

Serviceability

- Low voltage protection setting prolongs battery life time
- CANbus technology reduces wiring complexity and increases reliability
- The simple electronic components makes troubleshooting and servicing more efficient
- Hall effect sensors reduce wear and increase the component life



**Handle (Standard)
(Left & Right Handed)**



Adjustable Straddle Legs



One Sided (Cold Store)



Two Sided (Cold Store)

LOAD CHARTS

Load Centre Chart

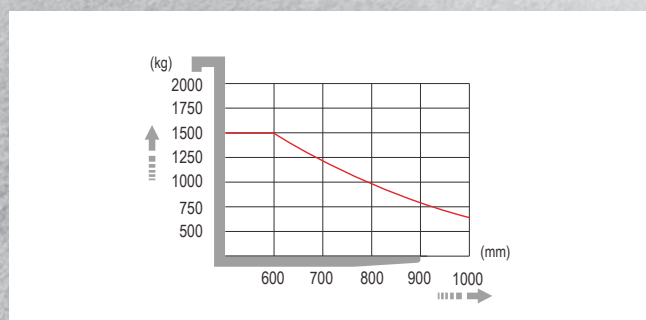

Load Capacity Chart

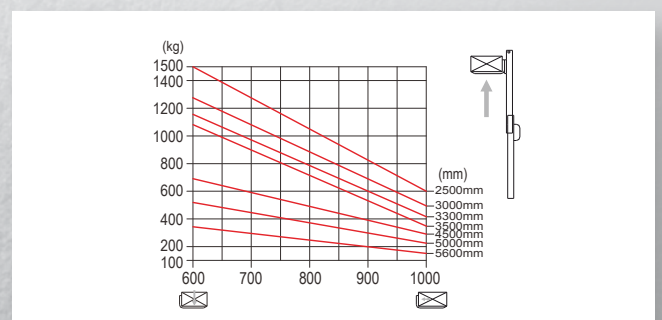

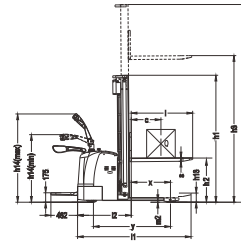
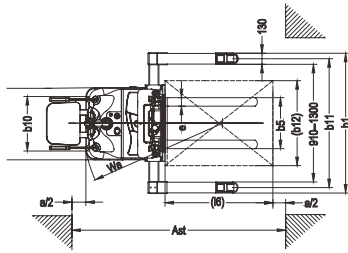

MODEL	MEASUREMENT	SL1.5UTS						
Load capacity	Q (kg)	1500						
Load centre distance	c (mm)	600						
Load distance, centre of drive axle to fork	x (mm)	697						
Fork height, lowered	h13 (mm)	70						
Wheelbase	y (mm)	1420						
Axle loading, laden front/rear	kg	1440/1280						
Axle loading, unladen front/rear	kg	870/350						
Tyres		polyurethane						
Tyre size, front	mm	Φ250×70						
Tyre size, rear	mm	Φ80×84						
Additional wheels (dimensions)	mm	Φ150×60						
Wheels, number front rear (x=driven wheels)		1x+1/4						
Tread, front	b10 (mm)	520						
Tread, rear	b11 (mm)	1040-1430						
Mast height lowered	h1 (mm)	1805	2055	2205	2305	2120	2280	2480
Free lift	h2 (mm)	0	0	0	0	1570	1740	1940
Max. lift height	h3 (mm)	2590	3090	3390	3590	4590	5090	5690
Mast height extended	h4 (mm)	3025	3525	3825	4025	5080	5560	6160
Height of tiller in drive position min./max.	h14 (mm)	1150/1450						
Overall length	l1 (mm)	2020						
Length to face of forks	l2 (mm)	962						
Overall width	b1 (mm)	1170-1560						
Fork dimensions	s/e/l (mm)	40/100/1070 (1150)						
Width overall forks	b5 (mm)	200-800						
Ground clearance, centre of wheelbase	m2 (mm)	35						
Aisle width for pallets 1000x1200 crossways	Ast (mm)	2560						
Aisle width for pallets 800x1200 lengthways	Ast (mm)	2545						
Turning radius	Wa (mm)	1695						
Steer Motor		Mechanical			Electronic			
Drive motor power	kW	1.2			1.5			
Lift motor power	kW	3.0						
Sound lever at the driver's ear according to DIN12503	dB (A)	70						
Travel speed, laden/unladen	Km/h	6.5/6.7						
Lift speed, laden/unladen	m/s	0.11/0.15						
Lowering speed, laden/unladen	m/s	0.12/0.12						
Max. gradeability, laden/unladen	%	8/15						
Service brake		Electromagnetic						
Battery voltage, nominal capacity K5	V/Ah	24/240						
Battery weight	kg	220						
Battery dimensions l/w/h	mm	675x254x500						
Service weight (without battery)	kg	1200/1225/1240/1250/1300/1320/1340						

SL1.5UTS Plug Type





HYSTER® DEALERS

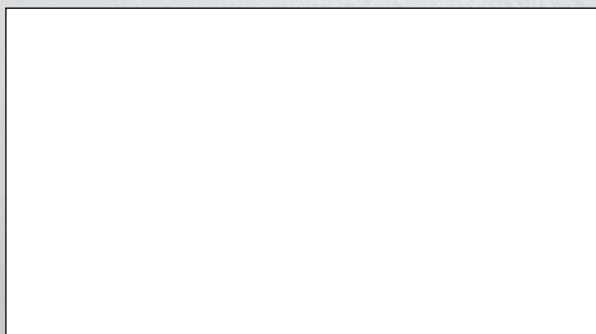

HYSTER PACIFIC

1 Bullecourt Avenue, Milperra NSW, Australia 2214
Tel: +61 (2) 9795 3800 Fax: +61 (2) 9792 8484
hyster.com/pacific/en-au

HYSTER ASIA

16 Tuas Avenue 20, Singapore 638827
Tel: +65 6863 3387 Fax: +65 6863 3349
hyster.com/asia/en-sg



/Hysterasiapacific



HysterJAPIC



Hyster Asia-Pacific